

NOTES: UNLESS OTHERWISE SPECIFIED

- 1 CATALOG NUMBER, DATE CODE AND MANUFACTURING LOCATION CODE LOCATED APPROXIMATELY AS SHOWN ON SURFACE INDICATED.
- 2 SOCKET COVER & SHIELD STAKED TOGETHER AND SHIPPED AS SEPARATE ASSEMBLY UNATTACHED TO CONNECTOR. DRAWING SHOWS CONNECTOR FULLY ASSEMBLED FOR REFERENCE ONLY.
- 3 THIS DIMENSION IS FINAL PLATED THRU HOLE SIZE.

4. MATERIAL & FINISH

C-PRESS[®] CONTACTS: COPPER ALLOY
 FINISH: C-SECTION: 30 MICROINCHES GOLD OVER 50 MICROINCHES NICKEL
 PRESS FIT END: PURE TIN

INSULATOR: POLYESTER, GLASS FILLED
 RATED UL 94V-0. COLOR: BLACK

SOCKET COVER: POLYESTER, GLASS FILLED
 RATED UL 94V-0. COLOR: BLACK

SHIELD: STEEL
 FINISH: PURE TIN

GROUND STRAP: PHOSPHOR BRONZE
 FINISH: PURE TIN

5. PERFORMANCE CHARACTERISTICS

INSULATION RESISTANCE: 5,000 MEGOHMS MINIMUM
 OPERATING TEMPERATURE RANGE: -55° C TO +105° C
 CURRENT RATING: 1 AMP AT 70° C
 3 AMP AT 20° C

C-PRESS[®] CONTACT:
 MAXIMUM INSERTION FORCE (PER CONTACT): 40 LBS. / 178 N MAXIMUM
 MINIMUM RETENTION FORCE (PER CONTACT): 10 LBS. / 44 N MINIMUM

REV	DESCRIPTION	BY DATE	APPD
A	RELEASED PER EWR08-ER9408	DW 07/24/08	WPM

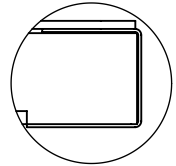

DETAIL A
SCALE 2 : 1

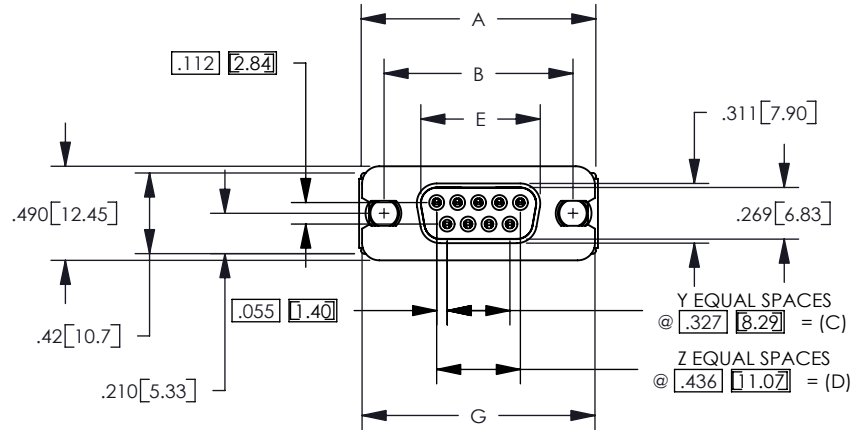

Y EQUAL SPACES
 @ .327 [8.29] = (C)
 Z EQUAL SPACES
 @ .436 [11.07] = (D)

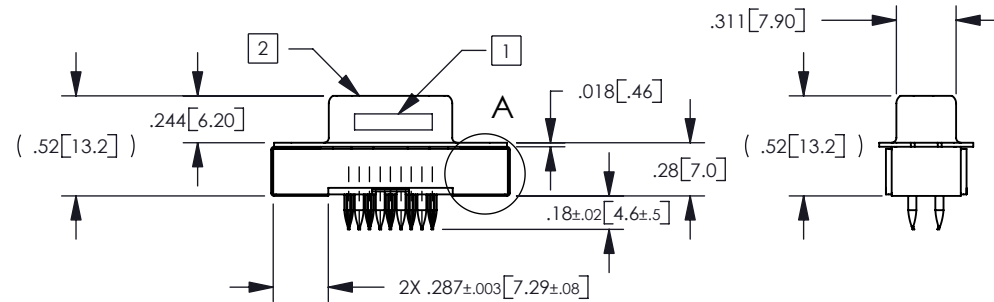
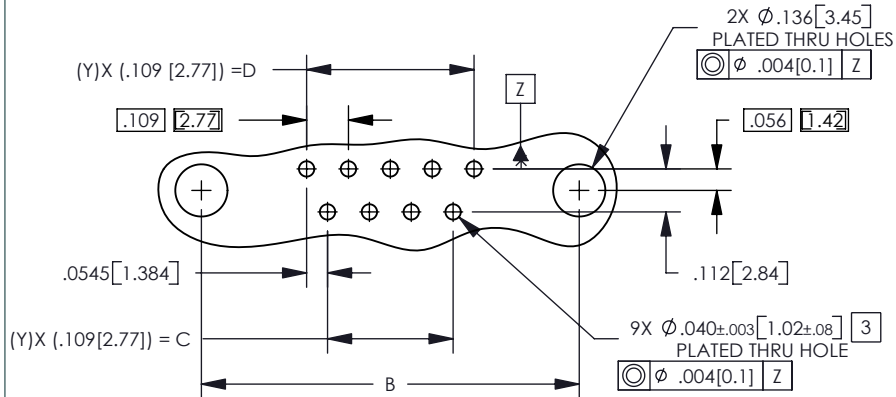

CATALOG P/N: 1891109S7K5554

RECOMMENDED PC BOARD REQUIREMENTS
 (COMPONENT SIDE OF BOARD SHOWN)

37	189-1137S-7-K5554	2.738/69.55	2.500/63.50	1.853/47.07	1.962/49.83	2.159/54.84	2.729/69.32	17	18
25	189-1125S-7-K5554	2.09/53.09	1.852/47.04	1.199/30.45	1.308/33.22	1.511/38.38	2.088/53.04	11	12
15	189-1115S-7-K5554	1.550/39.37	1.312/33.32	.654/16.61	.763/19.38	.971/24.66	1.541/39.14	6	7
9	189-1109S-7-K5554	.122/31.04	.984/24.99	.327/8.31	.436/11.07	.643/16.33	1.213/30.81	3	4
No. OF POSITIONS	CATALOG No.	A	B	C	D	E	G ±.015	Y	Z

PER ASME Y14.5M-1994
 UNLESS OTHERWISE SPECIFIED:
 DIMENSIONS ARE IN INCHES [MM]
 TOLERANCES:
 DECIMAL: .XX [X.X] ± .01 [0.3]
 .XXX [X.XX] ± .005 [0.13]
 .XXXX [X.XXXX] ± .XXXX
 ANGLES: ± 2°
 SCALE: 1:1



Winchester Electronics Corporation
 62 Barnes Industrial Road North
 Wallingford, Connecticut 06492

CUSTOMER DRAWING



D-SUB SHIELDED SOCKET CONNECTOR
 WITH C-PRESS SOCKET CONTACTS
 (ROHS WITH EXEMPTION)

DRAWN DW	DATE 07/24/08	APPROVED WPM	DATE 07/24/08
APPROVED VBH	DATE 07/24/08	APPROVED XXX	DATE XX/XX/XX

A	27432	SHT 1 OF 1	REV A
---	-------	------------	-------